

Setting Up Your E-mail in Windows 10 Mail

This tutorial shows you how to set up Windows 10 Mail to work with your e-mail account.

To Set Up Your E-mail Account in Windows 10 Mail

1. Open Windows 10 Mail, and Click **Get Started**

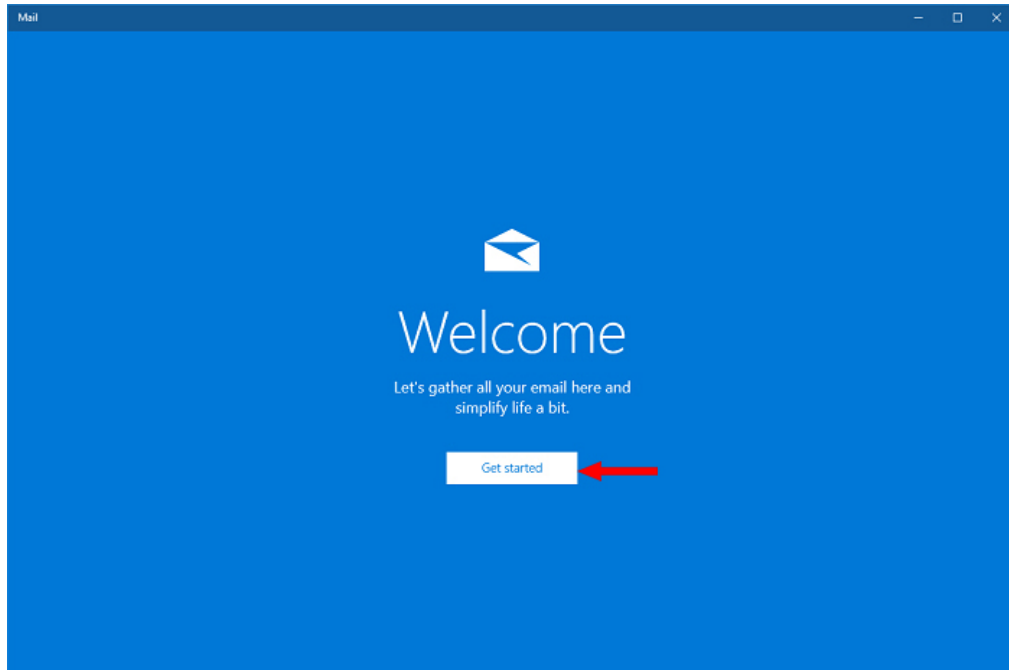

If you have setup an account in Windows 10 Mail before, click **Accounts in the left corner**

2. Click **Accounts**

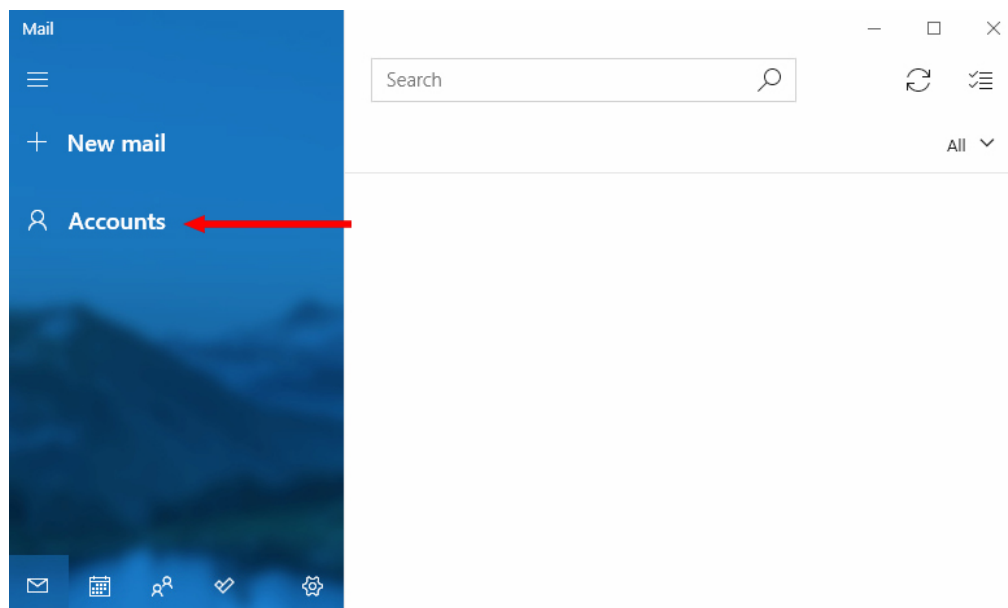

Webnix Technology Limited

Rm 802, 8/F, Koon Fook Center, No.9 Knutsford Terrace, TST, KLN
Email: cs@webnix.com
Tel: (852) 2720-8429 Fax: (852)2729-7751



3. Click **+ Add account**

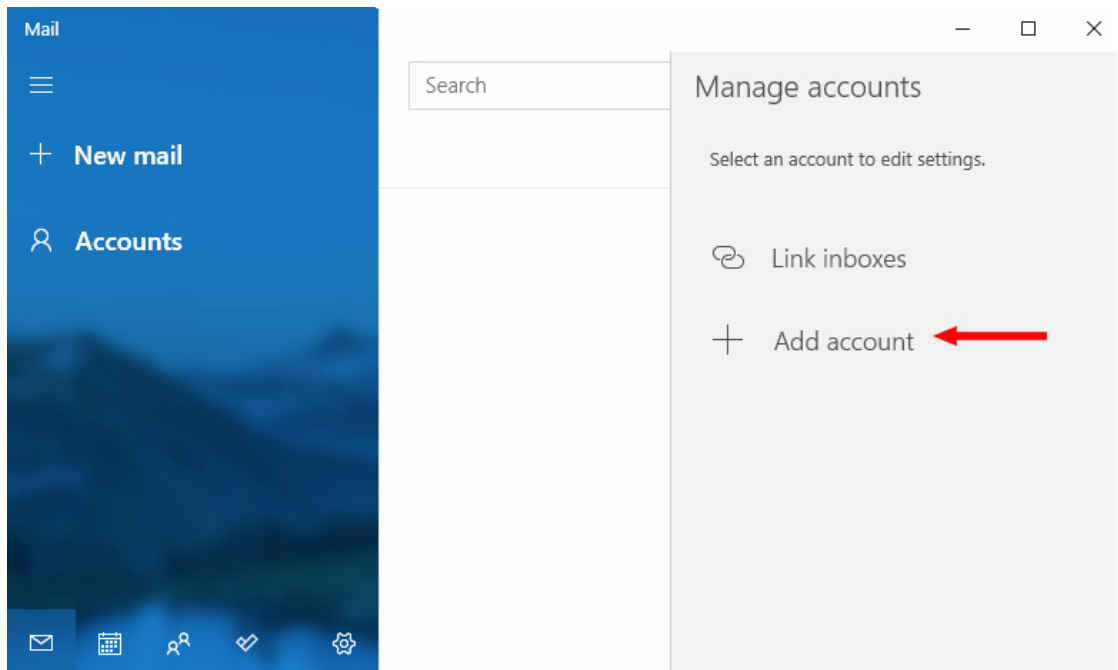

4. Click **Advanced setup**

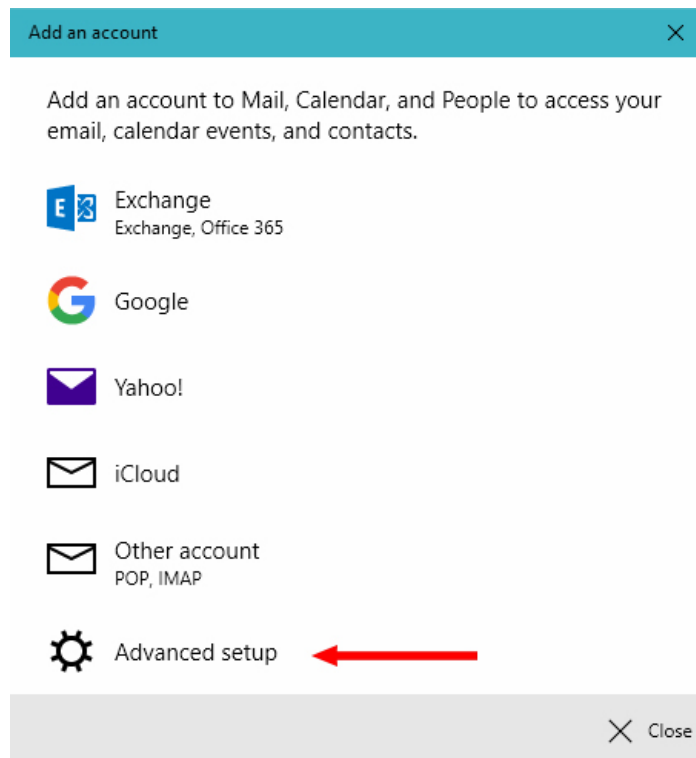
**Webnix Technology Limited**

Rm 802, 8/F, Koon Fook Center, No.9 Knutsford Terrace, TST, KLN
Email: cs@webnix.com
Tel: (852) 2720-8429 Fax: (852)2729-7751



5. Click **Internet email (POP or IMAP accounts that let you view your email in a web browser)**

Add an account

Advanced setup
Choose the kind of account you want to setup. If you're not sure, check with your service provider.

Exchange ActiveSync
Includes Exchange and other accounts that use Exchange ActiveSync.

Internet email
POP or IMAP accounts that let you view your email in a web browser.

Cancel

6. Enter your email account details as below

Internet email account

Email address
mobile@webnix.com

User name
mobile@webnix.com
Examples: kevinc, kevinc@contoso.com, domain\kevinc

Password
•••••

Account name
Webnix Demo Account

Send your messages using this name
Webnix Demo Account

Incoming email server
qm2.webnix.com

Account type
POP3

Outgoing (SMTP) email server
qm2.webnix.com:6025

Outgoing server requires authentication

Use the same user name and password for sending email

Require SSL for incoming email

Require SSL for outgoing email

Sign in Cancel

Webnix Technology Limited

Rm 802, 8/F, Koon Fook Center, No.9 Knutsford Terrace, TST, KLN
Email: cs@webnix.com
Tel: (852) 2720-8429 Fax: (852)2729-7751



Internet email account**Email address:** Your email address**User Name:** Your email address**Password:** Your email password**Account Name:** Your email address or other account description**Send your messages using this name:** Your email address or your name

Enter your domain name POP3 server address for your incoming mail server.

Incoming email server : mail.yourdomain.com

(For Example: your domain is yourdomain.com)

Enter your ISP SMTP server or Webnix SMTP server for your outgoing mail server.

a. Hong Kong (ISP) SMTP Server: (Using Default Port: 25)

- | | |
|--|-------------------------------------|
| 1. Netvigator (smtp.netvigator.com) | 6. PacificNet (smtp.pacific.net.hk) |
| 2. Biz Netviagtor (corpmail1.netvigator.com) | 7. Hutchcity (smtp.hutchcity.com) |
| 3. i-cable (smtp.i-cable.com) | 8. Wharf T&T (smtp2.wtt-mail.com) |
| 4. Hong Kong Boardband (smtp.hkbn.net) | 9. Pacific One Net (smtp.onebb.net) |
| 5. HKNet (smtp.hknet.com) | |

b. Webnix SMTP Server : Same as Incoming mail server : Port No (SMTP Port No: 6025)**Outgoing (SMTP) email server :** mail.yourdomain.com:6025

(For Example: your domain is yourdomain.com)

Tick the checkbox:**Outgoing server requires authentication****Use the same user name and password for sending email****Un-tick the checkbox:**

Require SSL for incoming email

Require SSL for outgoing email

Click **Sign In****Webnix Technology Limited**

Rm 802, 8/F, Koon Fook Center, No.9 Knutsford Terrace, TST, KLN

Email: cs@webnix.com

Tel: (852) 2720-8429 Fax: (852)2729-7751



- Basic account setup is completed. Click **Done**

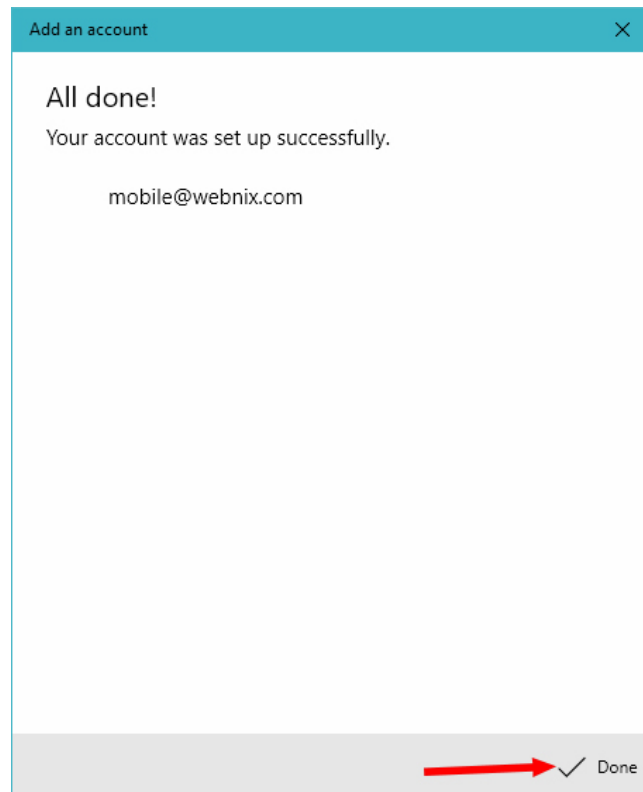

- You will see your message under INBOX

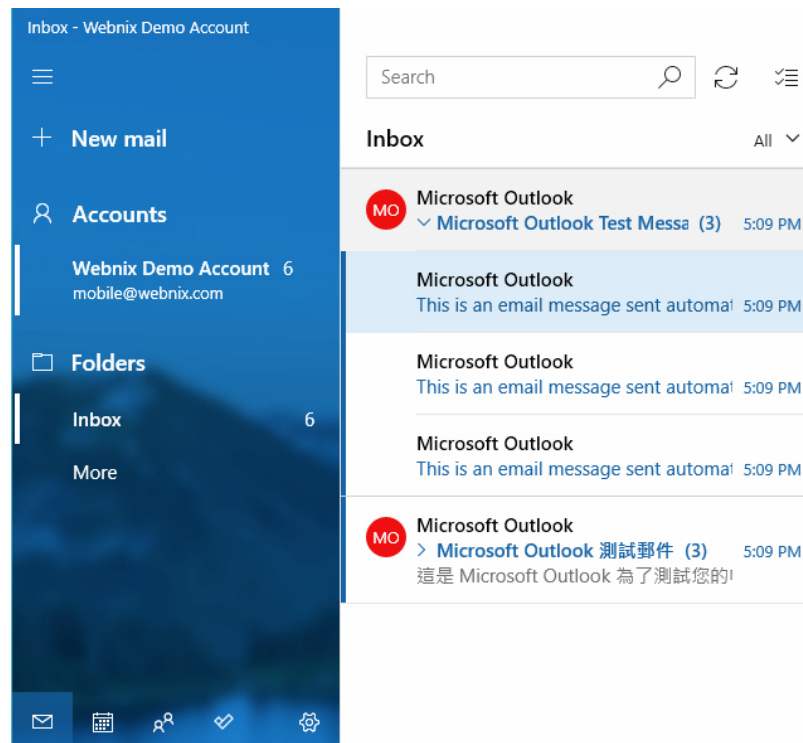

Webnix Technology Limited

Rm 802, 8/F, Koon Fook Center, No.9 Knutsford Terrace, TST, KLN

Email: cs@webnix.com

Tel: (852) 2720-8429 Fax: (852)2729-7751



- Change your email download behavior, click **Accounts** and your email account name under **Manage accounts**

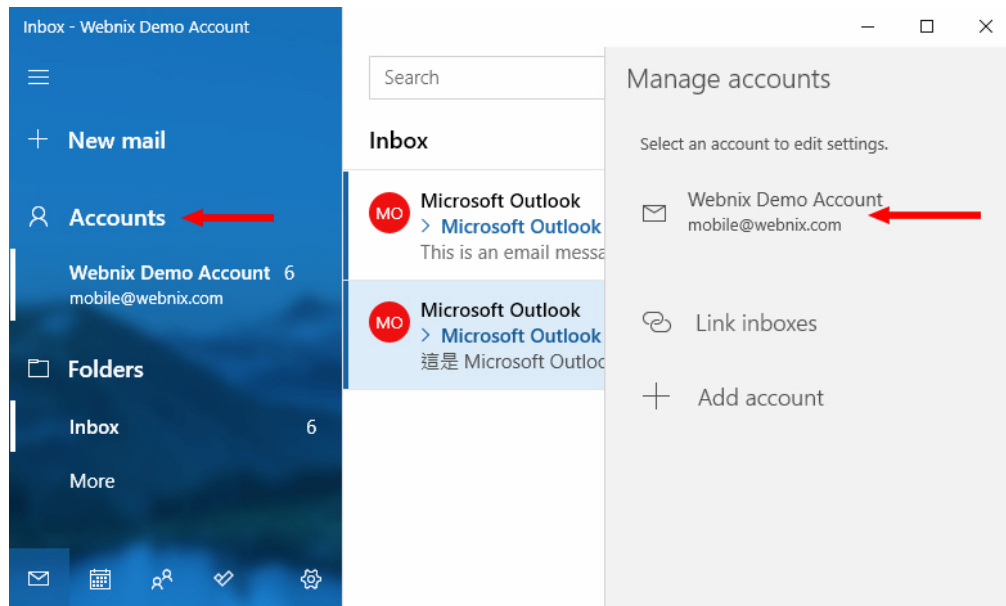

- Select **“Change mailbox sync settings”**

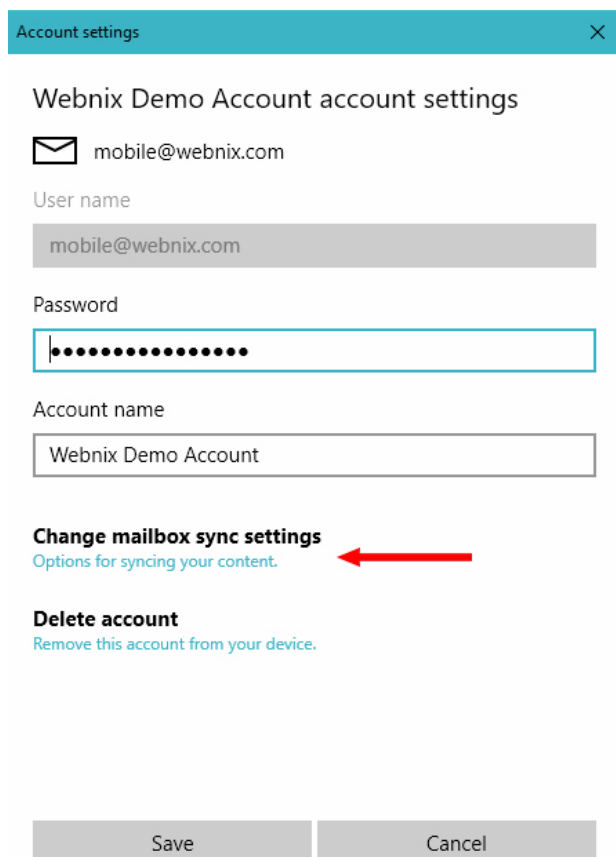
**We**

Rm 802, 8/F, Koon Fook Center, No.9 Knutsford Terrace, 151, KLN
Email: cs@webnix.com
Tel: (852) 2720-8429 Fax: (852)2729-7751

11. Select **any time** under **Download email from** and tick the checkbox **Always download full message and internet images**.

Sync options : On

Click **Done**

Account settings

Webnix Demo Account sync settings

Download new email
based on my usage

If you get a lot of mail one day or don't check your account for a few days, we'll change your sync settings accordingly to save you data and battery.

Currently syncing: every 2 hours

Always download full message and Internet images

Download email from
any time

Send your messages using this name
Webnix Demo Account

Sync options

Email
 On

Done Cancel

12. Click **Save** and Setup is finished.

Account settings

Webnix Demo Account account settings

mobile@webnix.com

User name
mobile@webnix.com

Password
.....

Account name
Webnix Demo Account

Change mailbox sync settings
[Options for syncing your content.](#)

Delete account
[Remove this account from your device.](#)

Save Cancel

Webnix Technology Limited

Rm 802, 8/F, Koon Fook Center, No.9 Knutsford Terrace, TST, KLN
Email: cs@webnix.com
Tel: (852) 2720-8429 Fax: (852)2729-7751

